

Bar Cover Tape  
See Note #3

Metal Fascia  
See Note #5

NOTE: Edge Caulk is required only on the dam side of strip-in on Bar Cover Tape applications. Both sides of Uncured EPDM Flashing require Edge Caulk.

1. Caulk metal joints. See Detail E-14.09.
2. All wood nailers to be approved material. Attachment of wood nailer to be accomplished by using fasteners providing no less than 125 lb (556 N) of pullout. Fasteners shall be spaced no greater than 12" o.c. (305 mm).
3. When using GenFlex Seam Tape and GenFlex Bar Cover Tape, first clean the membrane with GenFlex Cleaner. Then apply GenFlex Primer.
4. Metal coping cap, expansion joint, and edge details are typical only. All metalwork should be installed to sheet metal codes (SMACNA). Clean all metal prior to installation of GenFlex materials.

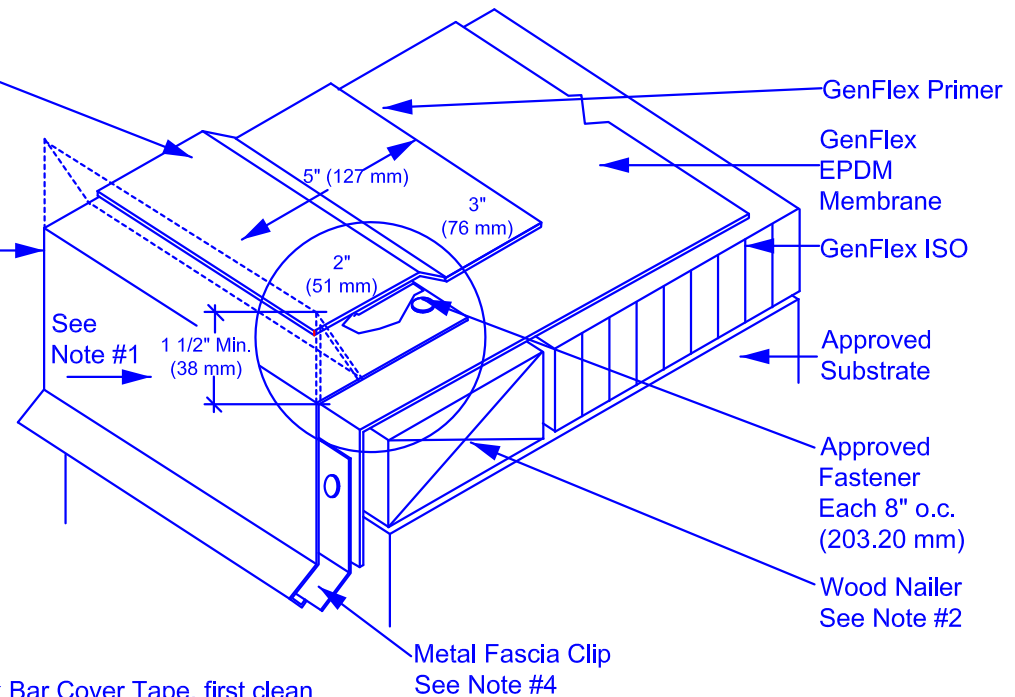

GenFlex Primer

GenFlex EPDM Membrane

GenFlex ISO

Approved Substrate

Approved Fastener Each 8" o.c. (203.20 mm)

Wood Nailer See Note #2

Metal Fascia Clip See Note #4

### Metal Gravel Stop

EPDM Systems

ACCEPTABLE SYSTEMS:  
All Systems

MAXIMUM WARRANTY: **20 Years**

ISSUE / REVISION DATE:  
6-25-2015

NOT TO SCALE

DETAIL NO.

**E-14.01**