

Firestone Building Products

EPDM Training – Drains and Scuppers

Firestone
BUILDING PRODUCTS



Details: Roof Drain

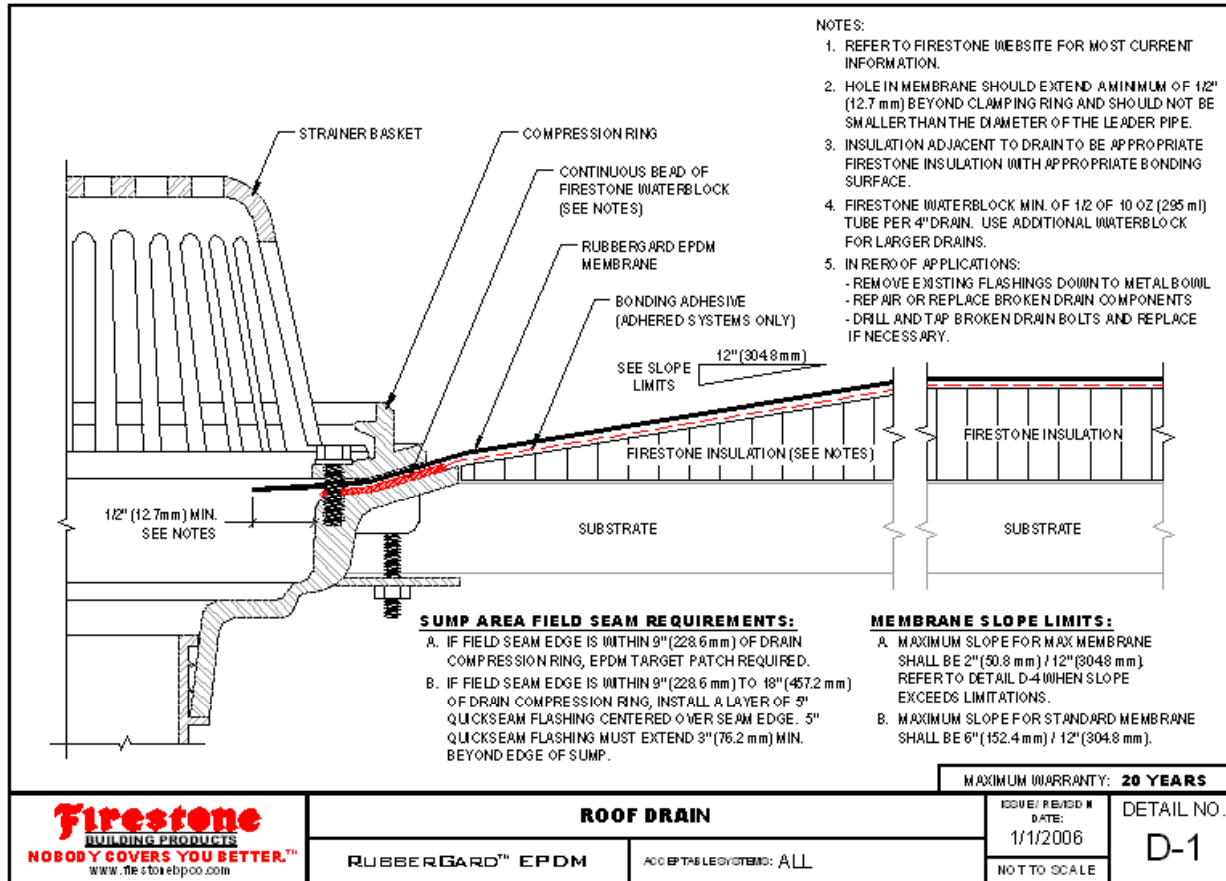



Details: Roof Drain with Overflow Roof Drain

NOTES:

1. REFER TO FIRESTONE WEBSITE FOR MOST CURRENT INFORMATION.
2. HOLE IN MEMBRANE SHOULD EXTEND A MINIMUM OF 1/2" (12.7 mm) BEYOND CLAMPING RING AND SHOULD NOT BE SMALLER THAN THE DIAMETER OF THE LEADER PIPE.
3. INSULATION ADJACENT TO DRAIN TO BE APPROPRIATE FIRESTONE INSULATION WITH APPROPRIATE BONDING SURFACE.
4. FIRESTONE WATERBLOCK MIN. OF 1/2 OF 10 OZ (295 ml) TUBE PER 4" DRAIN. USE ADDITIONAL WATERBLOCK FOR LARGER DRAINS.
5. IN REERO OF APPLICATIONS:
 - REMOVE EXISTING FLASHINGS DOWN TO METAL BOWL
 - REPAIR OR REPLACE BROKEN DRAIN COMPONENTS
 - DRILL AND TAP BROKEN DRAIN BOLTS AND REPLACE IF NECESSARY.

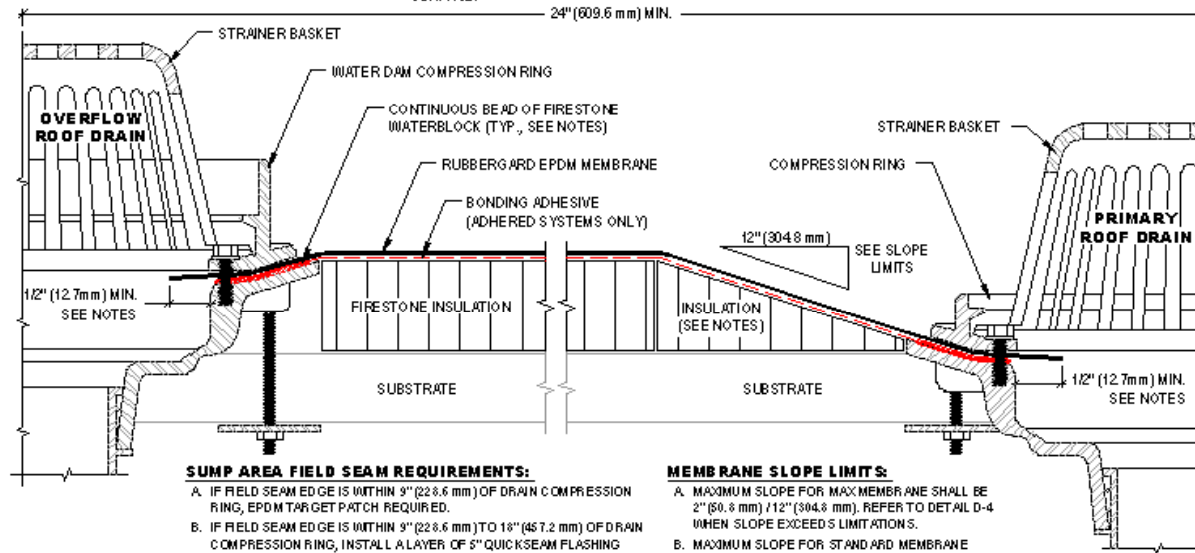

SUMP AREA FIELD SEAM REQUIREMENTS:

- A. IF FIELD SEAM EDGE IS WITHIN 9" (228.6 mm) OF DRAIN COMPRESSION RING, EPDM TARGET PATCH REQUIRED.
- B. IF FIELD SEAM EDGE IS WITHIN 9" (228.6 mm) TO 18" (457.2 mm) OF DRAIN COMPRESSION RING, INSTALL A LAYER OF 5" QUICKSEAM FLASHING CENTERED OVER SEAM EDGE. 5" QUICKSEAM FLASHING MUST EXTEND 3" (76.2 mm) MIN. BEYOND EDGE OF SUMP.

MEMBRANE SLOPE LIMITS:

- A. MAXIMUM SLOPE FOR MAX MEMBRANE SHALL BE 2" (50.8 mm) / 12" (304.8 mm). REFER TO DETAIL D-4 WHEN SLOPE EXCEEDS LIMITATIONS.
- B. MAXIMUM SLOPE FOR STANDARD MEMBRANE SHALL BE 6" (152.4 mm) / 12" (304.8 mm).

MAXIMUM WARRANTY: **20 YEARS**

Firestone
BUILDING PRODUCTS
NOBODY COVERS YOU BETTER.™
www.firestonepro.com

ROOF DRAIN WITH OVERFLOW ROOF DRAIN

RUBBERGARD™ EPDM

ACCEPTABLE SYSTEMS: ALL

ISSUE / REVISION DATE:
1/1/2006
NOT TO SCALE

DETAIL NO.
D-5





Details: Roof Drain

Improper Application





Details: Roof Drain

Proper Application





Roof Drain Tips

- All drain bolts must be in place and tight.
- Firestone Waterblock must be present between the base of the drain and the membrane. Rule of Thumb: 1 tube per drain.
- Slope should not exceed 6/12 for standard Rubbergard EPDM, and 2/12 for Rubbergard MAX EPDM.
- Field seams within 9" require a target patch.
- Field seams within 9"-18" must be stripped in with Firestone 5' Quickseam Flashing.
- Hole in membrane should extend a minimum of 1/2" beyond the clamping ring and should not be smaller than the diameter of the drain pipe.





Details: Scuppers – Steps 1 & 2

STEP #1

NOTES:

- STEP #1 - APPLY CONTINUOUS BEAD OF FIRESTONE WATERBLOCK CENTERED UNDER NAILS. FASTEN METAL SCUPPER WITH APPROPRIATE FASTENERS AND ROUND ALL CORNERS OF SCUPPER.
- STEP #2 - STRIP IN ALL EXPOSED EDGES OF SCUPPER AS INDICATED WITH 5\"/>

STEP #2

Firestone BUILDING PRODUCTS NOBODY COVERS YOU BETTER.™ www.firestonebuildingproducts.com	THRU-WALL SCUPPER (WELDED SLEEVE) INSTALLATION STEPS 1 & 2	ISSUE / REVISION # DATE: 1/1/2006	DETAIL NO. S-1a
RUBBERGARD™ EPDM	ACCEPTABLE SYSTEMS: ALL	NOT TO SCALE	MAXIMUM WARRANTY: 20 YEARS





Details: Scuppers – Steps 3 & 4

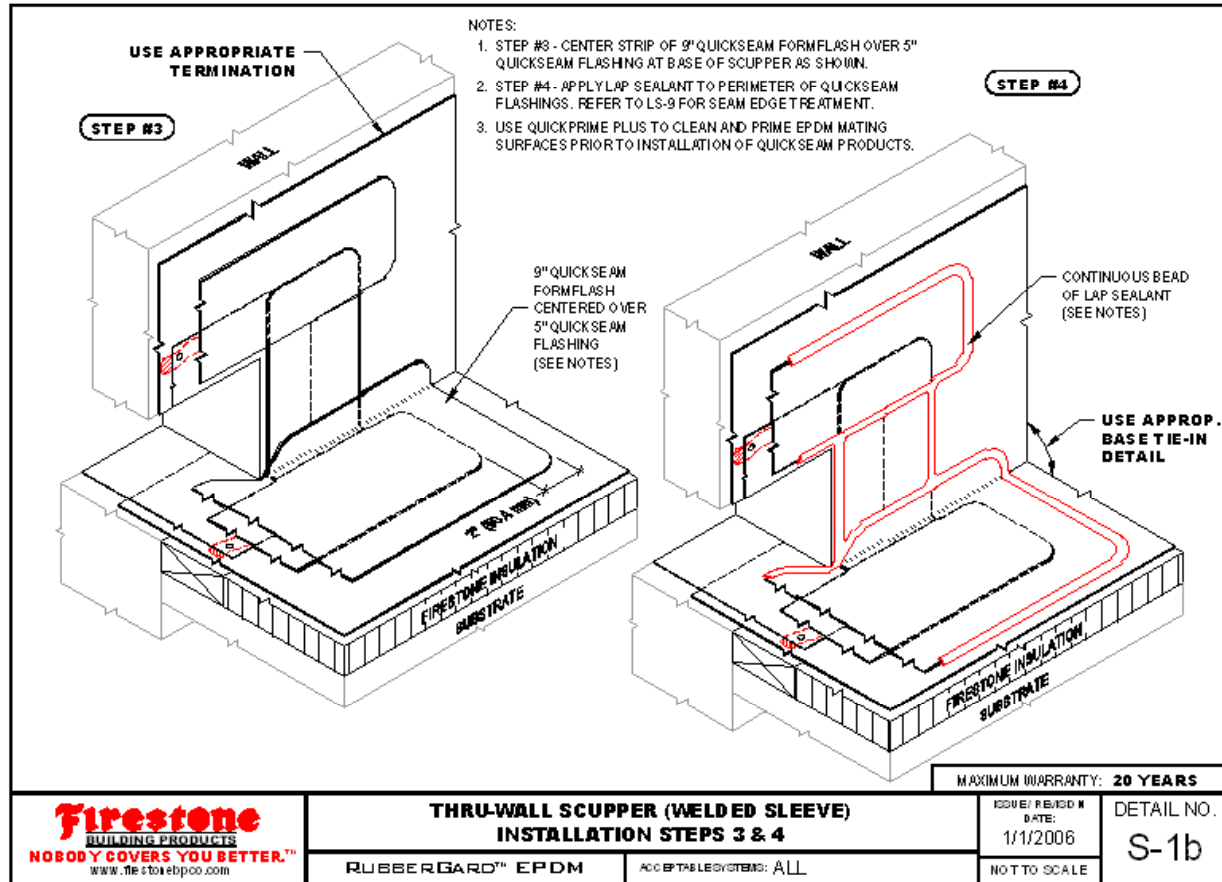



Details: Scuppers

Improper Application



No flashing present.

10.02.2007





Details: Scuppers

Proper Application





Scupper Tips

- Use primer to clean and prime all surfaces where all Quickseam products will be applied.
- Apply Firestone Waterblock centered under the nail holes before nailing the metal sleeve down.
- Roller apply all Quickseam products from the inside, outward to avoid air bubbles.
- Apply Lap Sealant as required.

